



# CONTROLLER KEYPAD

## USER GUIDE

COLOR KINETICS INCORPORATED  
 10 MILK STREET, SUITE 1100  
 BOSTON, MA 02108  
 TEL 888 FULL RGB  
 TEL 617 423 9999  
 FAX 617 423 9998  
 INFO@COLORKINETICS.COM  
 WWW.COLORKINETICS.COM

## INTRODUCING THE CONTROLLER KEYPAD

The Color Kinetics® Controller Keypad is a wall-mounted keypad for use with iPlayer® 2. It has eight buttons for selecting shows, onboard LEDs to indicate the current show, dimmer controls, and a master OFF switch.

Fig. 1

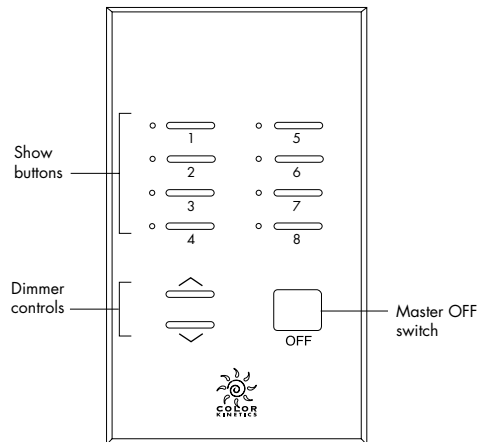

### Included in This Box:

- Controller Keypad
- Serial Cable (20')

### Additional Items You'll Need:

- iPlayer® 2 (Item# 103-000007-00)
- One-gang wall box

## INSTALLATION

This product should be installed by a qualified electrician in accordance with NEC and relevant local codes.

**WARNING:** Make sure the power is off before connecting or disconnecting the keypad.

### WIRING THE KEYPAD

The Controller Keypad comes packaged with a 20' serial cable. This cable has a standard DB9M connector at one end, and flying leads at the other. The DB9M connector connects to the iPlayer 2 serial port, and the flying leads connect to the back of the Controller Keypad.

ITEM# 103-000009-00

©2001 Color Kinetics Incorporated. All rights reserved. Chromacore, Color Kinetics, the Color Kinetics logo, iColor, and iPlayer are registered trademarks and ColorBlast, ColorPlay, Coup de Color, and Smartjuice are trademarks of Color Kinetics Incorporated.

All other brand or product names are trademarks or registered trademarks of their respective owners.

Specifications are subject to change without notice.

PUB-000061-00 Rev 00

- Connect the serial cable to the iPlayer 2 Serial port.
- Connect the flying leads to the Controller Keypad screw terminals as shown in Fig. 2.

Fig. 2

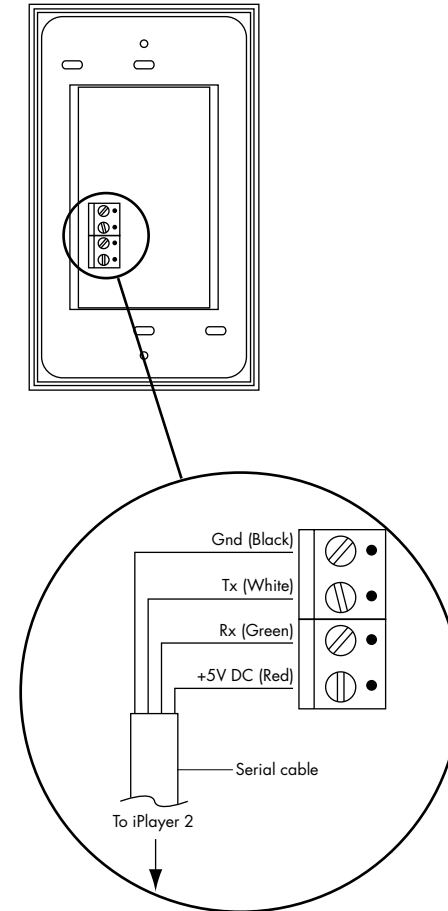

### MOUNTING THE KEYPAD

The Controller Keypad mounts directly to a standard US one-gang wall box.

- Install the wall box, keeping in mind that the serial cable must reach from iPlayer 2 to the Controller Keypad.

**NOTE:** If you use custom wiring in place of the serial cable, be aware that the maximum allowable run from iPlayer 2 to the Controller Keypad is 50'.

- Remove the faceplate from the Controller Keypad by grasping the top edge of the faceplate and prying it gently away from the keypad.

Fig. 3

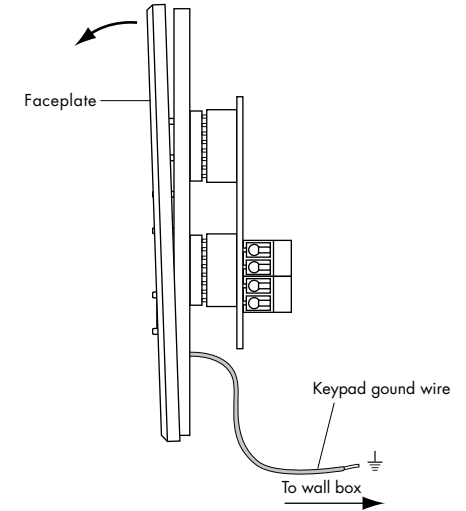

- Connect the keypad ground wire to the inside of the wall box. (See Fig. 3.)
- Mount the keypad to the wall box using two mounting screws.

Fig. 4

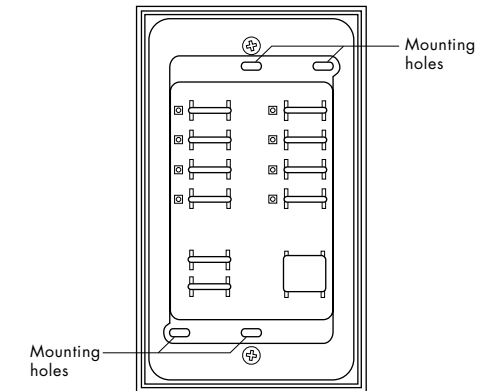

- Replace the faceplate by pressing it gently onto the keypad until it snaps into place.

## SERIAL CABLE PINOUTS (DB9M)

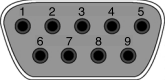

- 1** No connection
- 2** RxD (connects to iPlayer 2 TxD pin)
- 3** TxD (connects to iPlayer 2 RxD pin)
- 4** +5V DC input
- 5** Ground
- 6–9** No connection

## USING THE CONTROLLER KEYPAD

- Use Color Kinetics QuickPlay™ to download light shows to iPlayer 2 and assign triggers to each show. (Refer to the QuickPlay online help system for details.)
- Press a show button (1–8) to play the show that is assigned to that trigger. Shows play from the beginning at 100% brightness.
- If you press a show button that does not have a valid show assigned to it, all lights will turn off and the keypad LED will flash.
- Use the dimmer controls to adjust the brightness from 10% to 100%. Press and hold the dimmer controls to fade up or down.
- Press the OFF button to turn all lights off.

## PRODUCT SPECIFICATIONS

<b>HOUSING</b>	White matte plastic faceplate and buttons
<b>WEIGHT</b>	3.0 oz (85 g)
<b>DATA CONNECTOR</b>	Screw terminal
<b>POWER CONNECTOR</b>	Screw terminal

### ELECTRICAL SPECIFICATIONS

<b>POWER REQUIREMENT</b>	50mA @ 5V DC (0.25W)
<b>POWER SUPPLY</b>	None required (powered by iPlayer 2)

